

# TEL-TRU Bimetal Thermometers

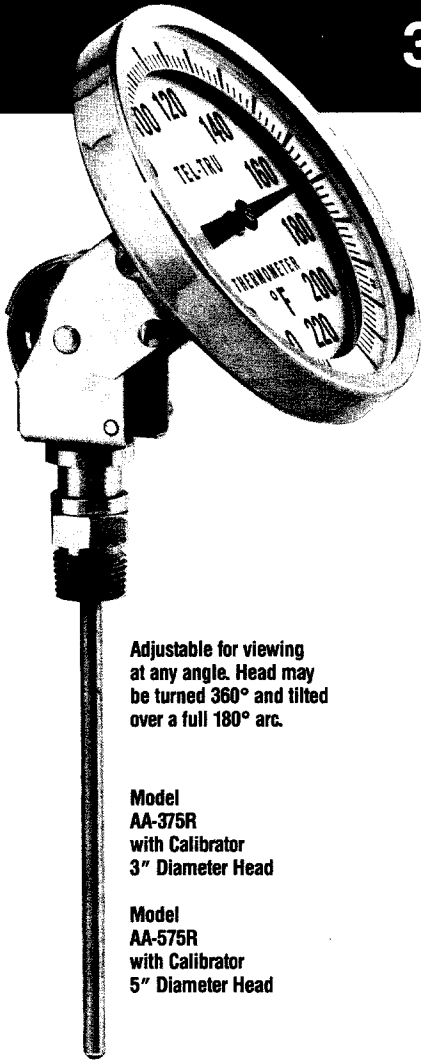

**World Class  
Thermometers**

# 3" & 5" Industrial Thermometers



Adjustable for viewing at any angle. Head may be turned 360° and tilted over a full 180° arc.

**Model AA-375R with Calibrator 3" Diameter Head**

**Model AA-575R with Calibrator 5" Diameter Head**

- Type 304 stainless steel.
- All welded construction.
- Easy to calibrate by inserting Allen wrench into reset opening.
- Anti-Parallax dial avoids reading errors.
- Dials printed with large black numbers and graduations on raised ring—easy to read from any angle.
- Rustproof—Dustproof—Leakproof. Hermetically sealed.
- Corrosion resistant to most chemicals.
- Connection Nut: 1/2" NPT standard. Can be supplied with Union Connection or other NPT sizes at extra charge.
- Stem Diameter: 1/4". Standard stem lengths: 2 1/2", 4", 6", 9", 12", 15", 18", 24", including threads. Available in stem lengths up to 72".
- Actuated by super-sensitive bimetallic Helix Coil.
- Bimetal element dampened with silicone for minimum pointer vibration and maximum heat transfer.
- Accuracy to within ± 1% total scale range.
- Over-range protection 100% up to 250°F, 50% up to 500°F, 10% above 500°F.
- Extra-heavy glass crystal. Plastic or tempered crystal can be supplied at extra charge.

## Adjustable Angle

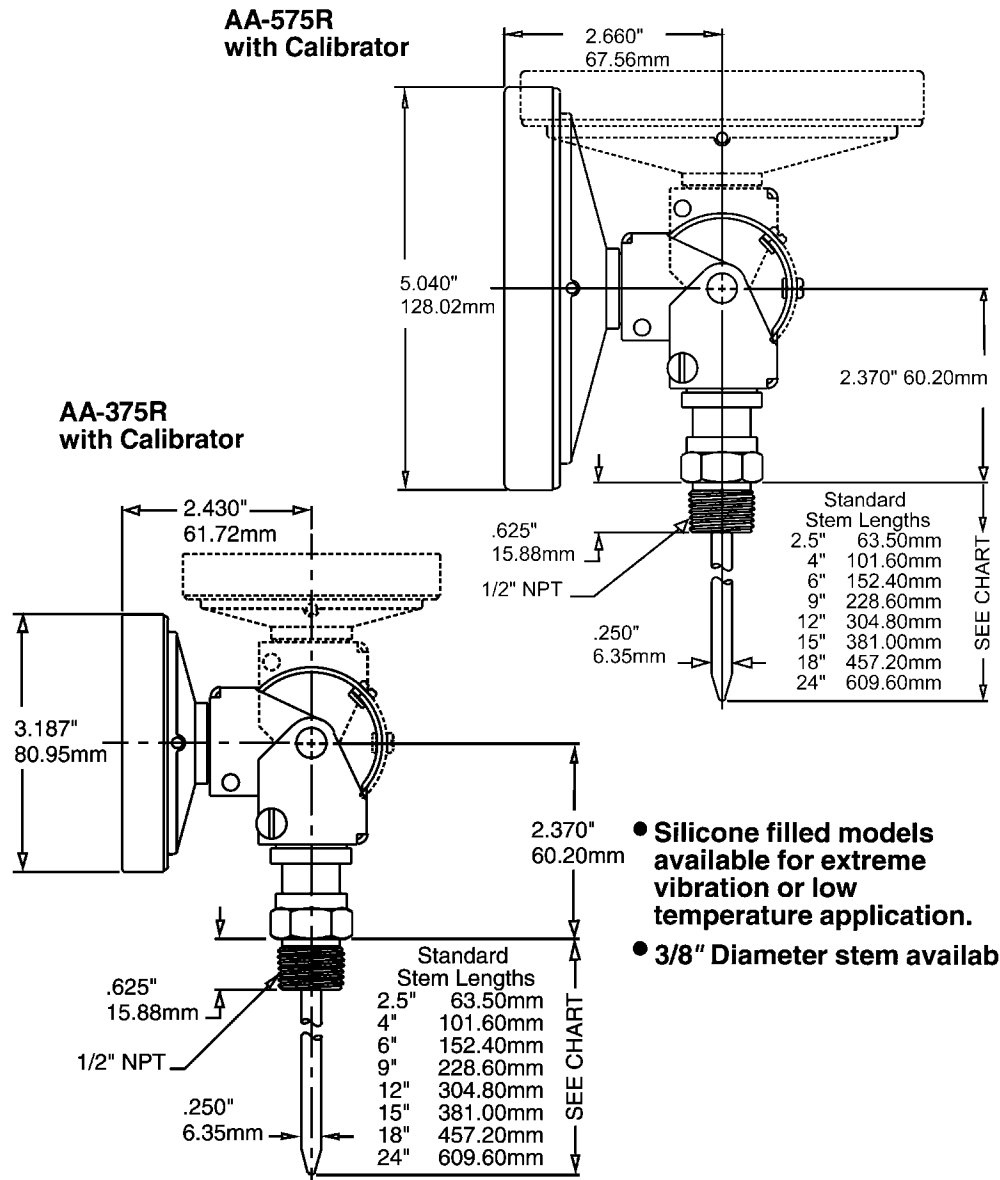

- Silicone filled models available for extreme vibration or low temperature application.
- 3/8" Diameter stem available.

## Temperature Ranges

Fahrenheit	°/Div.	Celsius	°/Div.	°F	°C
-100 to 100°	2°	-50 to 100°	1°	-100/100	-75/40
-40 to 160°	2°	-50 to 50°	1°	-40/160	-40/70
0 to 140°	1°	-50 to 25°	1°	0/180	-18/82
0 to 180°	2°	-40 to 70°	1°	0/220	-10/100
0 to 220°	2°	-10 to 110°	1°	20/240	-10/110
20 to 240°	2°	0 to 50°	1/2°	25/125	0/50
25 to 125°	1°	0 to 100°	1°	50/300	10/150
50 to 250°	2°	0 to 150°	1°	50/400	0/200
50 to 300°	2°	0 to 200°	2°	50/500	0/250
50 to 400°	5°	0 to 250°	2°	150/750	50/400
50 to 500°	5°	0 to 300°	5°	*200/1000	100/550
150 to 750°	10°	100 to 400°	5°		
*200 to 1000°	10°	*100 to 550°	5°		

\*Not recommended for continuous use above 800°F or 425°C

Additional dial ranges and stem lengths available.

Thermowells are recommended for pressure, corrosive fluid or high velocity applications.

## Order by Specifying

1. Model Number
2. Temperature Range.
3. Stem Length.
4. Connection Nut Size.
5. Optional Features or Accessories required.
6. Any application other than normal, such as over range, high pressure or corrosive conditions. Give details.
7. If head is subjected to temperatures in excess of 300°F, state temperature.

## Shipping Weight

AA-375R	1 lb.
AA-575R	2 lb.

## IMMERSION

For most accurate reading with Tel-Tru thermometers immerse past groove on lower portion of stem.

2 1/2" stem thermometers should be completely immersed. If used with a limited space thermowell some reading error may be noticed depending on process and ambient temperatures. Consult with factory for further information.



Manufactured in USA by:  
**TEL-TRU Manufacturing Co.**  
 P.O. Box 144  
 Rochester, NY 14601 USA  
 Phone: 716-232-1440 • 800-232-5335  
 FAX: 716-232-3857  
 Manufacturers of Precision Products Since 1916

## ASME B40.3

Bimetal thermometers manufactured by Tel-Tru and offered in this catalog are designed to meet or exceed this Standard issued by the American Society of Mechanical Engineers.



# 3" & 5" Industrial Thermometers

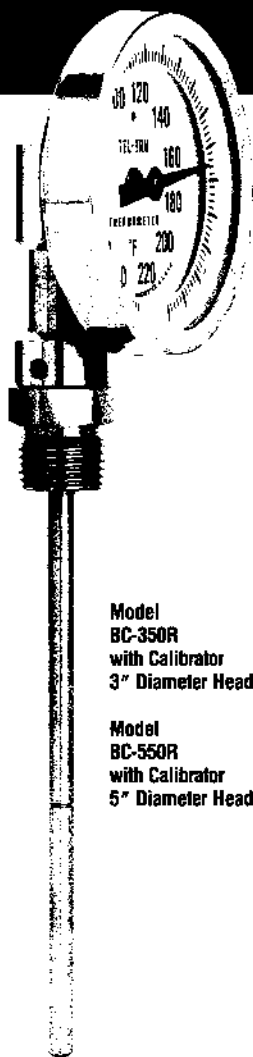

Model BC-350R with Calibrator 3" Diameter Head

Model BC-550R with Calibrator 5" Diameter Head

- Type 304 stainless steel.
- All welded construction.
- Easy to calibrate by loosening 2 socket head screws above hex connecting nut.
- Anti-Parallax dial avoids reading errors.
- Dials printed with large black numbers and graduations on raised ring—easy to read from any angle.
- Rustproof—Dustproof—Leakproof. Hermetically sealed.
- Corrosion resistant to most chemicals.
- Connection Nut: 1/2" NPT standard. Can be supplied with Union Connection or other NPT sizes at extra charge.
- Stem Diameter: 3/8". Standard stem lengths: 2 1/2", 4", 6", 9", 12", 15", 18", 24", including threads. Available in stem lengths up to 72".
- Actuated by super-sensitive bimetallic Helix Coil.
- Bimetal element dampened with silicone for minimum pointer vibration and maximum heat transfer.
- Accuracy to within ± 1% total scale range.
- Over-range protection 100% up to 250°F, 50% up to 500°F, 10% above 500°F.
- Extra-heavy glass crystal. Plastic or tempered crystal can be supplied at extra charge.
- Stem can be located at any position around the entire circumference of the head.



Manufactured in USA by:  
**TEL-TRU Manufacturing Co.**  
 P.O. Box 144  
 Rochester, NY 14601 USA  
 Phone: 716-232-1440 • 800-232-5335  
 FAX: 716-232-3857  
*Manufacturers of Precision Products Since 1916*

## Bottom Connected

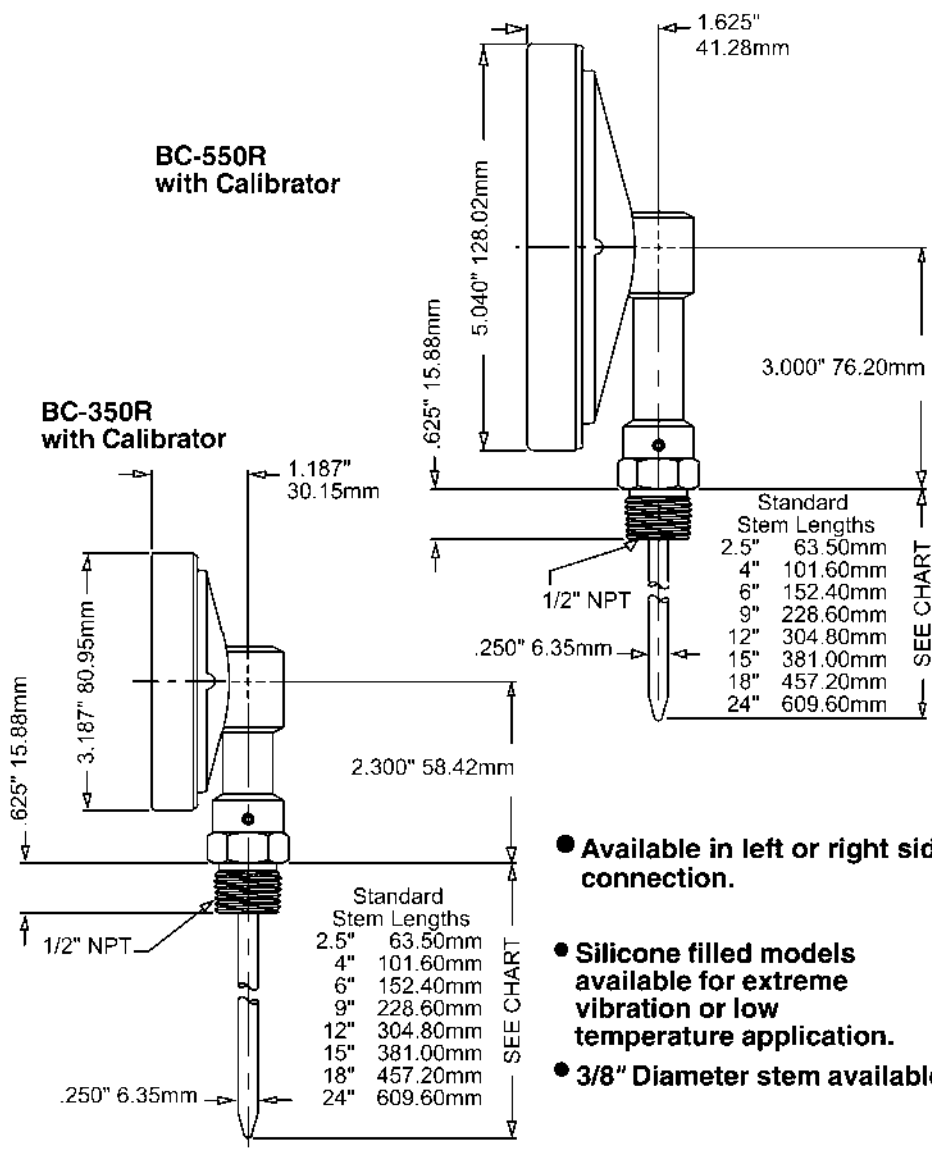

- Available in left or right side connection.
- Silicone filled models available for extreme vibration or low temperature application.
- 3/8" Diameter stem available.

Temperature Ranges					
Fahrenheit	%Div.	Celsius	%Div.	Dual °F	Dual °C
-100 to 100°	2°	-50 to 100°	1°	-100/100	-75/40
-40 to 160°	2°	-50 to 50°	1°	-40/160	-40/70
0 to 140°	1°	-50 to 25°	1°	0/180	-18/82
0 to 180°	2°	-40 to 70°	1°	0/220	-10/100
0 to 220°	2°	-10 to 110°	1°	20/240	-10/110
20 to 240°	2°	0 to 50°	1/2°	25/125	0/50
25 to 125°	1°	0 to 100°	1°	50/300	10/150
50 to 250°	2°	0 to 150°	1°	50/400	0/200
50 to 300°	2°	0 to 200°	2°	50/500	0/250
50 to 400°	5°	0 to 250°	2°	150/750	50/400
50 to 500°	5°	0 to 300°	5°	*200/1000	100/550
150 to 750°	10°	100 to 400°	5°		
*200 to 1000°	10°	*100 to 550°	5°		

\*Not recommended for continuous use above 800°F or 425°C

Additional dial ranges and stem lengths available.

Thermowells are recommended for pressure, corrosive fluid or high velocity applications.

**ASME B40.3**  
 Bimetal thermometers manufactured by Tel-Tru and offered in this catalog are designed to meet or exceed this Standard issued by the American Society of Mechanical Engineers.

## Order by Specifying

1. Model Number
2. Temperature Range.
3. Stem Length.
4. Connection Nut Size.
5. Optional Features or Accessories required.
6. Any application other than normal, such as over range, high pressure or corrosive conditions. Give details.
7. If head is subjected to temperatures in excess of 300°F, state temperature.

## Shipping Weight

BC-350R ..... 12 oz.  
 BC-550R ..... 1 lb. 10 oz.

**IMMERSION**  
 For most accurate reading with Tel-Tru thermometers immerse past groove on lower portion of stem.  
 2 1/2" stem thermometers should be completely immersed. If used with a limited space thermowell some reading error may be noticed depending on process and ambient temperatures. Consult with factory for further information.

# 3" & 5" Industrial Thermometers

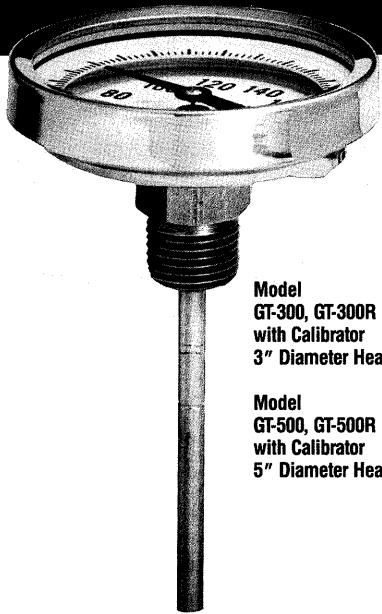

**Model  
GT-300, GT-300R  
with Calibrator  
3" Diameter Head**

**Model  
GT-500, GT-500R  
with Calibrator  
5" Diameter Head**

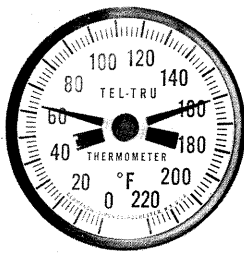

**Model  
MX-325R Max. or Min.  
with Calibrator  
3" Diameter Head**

**Model  
MM-325R Max. Min.  
Also Available**

- Type 304 stainless steel.
- All welded construction.
- Models GT-300R, MX-325R, GT-500R are easy to calibrate by inserting Allen wrench into reset opening.
- Anti-Parallax dial avoids reading errors.
- Dials printed with large black numbers and graduations on raised ring—easy to read from any angle.
- Rustproof—Dustproof—Leakproof. Hermetically sealed.
- Corrosion resistant to most chemicals.
- Connection Nut: 1/2" NPT standard. Can be supplied in other NPT sizes at extra charge.
- Stem Diameter: 1/4". Standard stem lengths: 2 1/2", 4", 6", 9", 12", 15", 18", 24", including threads. Available in stem lengths up to 72".
- Actuated by super-sensitive bimetallic Helix Coil.
- Bimetal element dampened with silicone for minimum pointer vibration and maximum heat transfer.
- Accuracy to within ± 1% total scale range. When using Max. or Min. temperature indicator, accurate to within 1 1/2% total scale range.
- Over-range protection 100% up to 250°F, 50% up to 500°F, 10% above 500°F.
- Extra-heavy glass crystal. Plastic or tempered crystal can be supplied at extra charge.



Manufactured in USA by:  
**TEL-TRU Manufacturing Co.**  
P.O. Box 144  
Rochester, NY 14601 USA  
Phone: 716-232-1440 • 800-232-5335  
FAX: 716-232-3857  
Manufacturers of Precision Products Since 1916

## GT-300, GT-300R with Calibrator

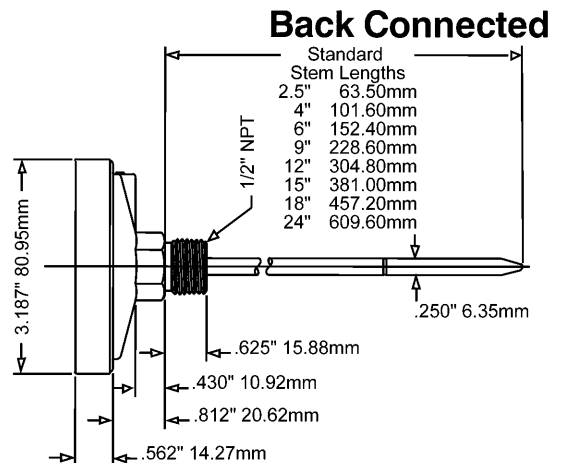

## GT-500, GT-500R with Calibrator

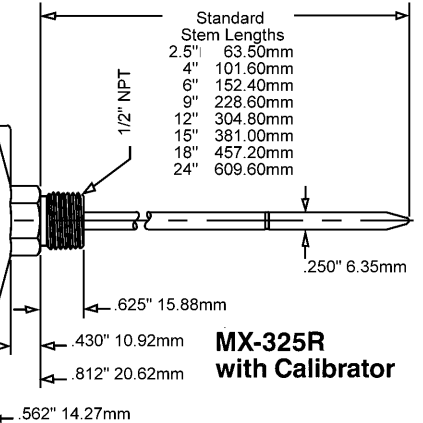
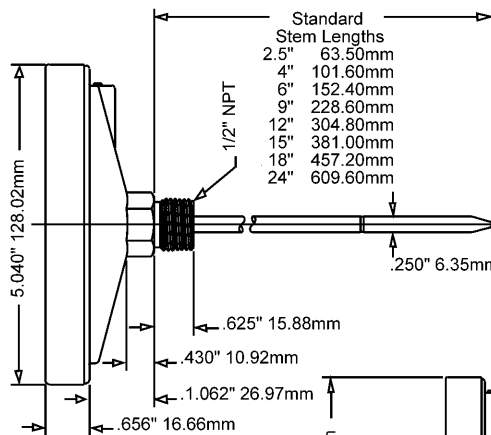

- Silicone filled models available for extreme vibration or low temperature applications.

- 3/8" Diameter stem available.

### Temperature Ranges

Fahrenheit	%Div.	Celsius	%Div.	Dual °F	Dual °C
-100 to 100°	2°	-50 to 100°	1°	-100/100	-75/40
-40 to 160°	2°	-50 to 50°	1°	-40/160	-40/70
0 to 140°	1°	-50 to 25°	1°	0/180	-18/82
0 to 180°	2°	-40 to 70°	1°	0/220	-10/100
0 to 220°	2°	-10 to 110°	1°	20/240	-10/110
20 to 240°	2°	0 to 50°	1/2°	25/125	0/50
25 to 125°	1°	0 to 100°	1°	50/300	10/150
50 to 250°	2°	0 to 150°	1°	50/400	0/200
50 to 300°	2°	0 to 200°	2°	50/500	0/250
50 to 400°	5°	0 to 250°	2°	150/750	50/400
50 to 500°	5°	0 to 300°	5°	†200/1000	100/550
150 to 750°	10°	100 to 400°	5°		
†200 to 1000°	10°	†100 to 550°	5°		

\*Not recommended for continuous use above 800°F or 425°C

†Available in Calibrator models only.

Additional dial ranges and stem lengths available.

Thermowells are recommended for pressure, corrosive fluid or high velocity applications.

### ASME B40.3

Bimetal thermometers manufactured by Tel-Tru and offered in this catalog are designed to meet or exceed this Standard issued by the American Society of Mechanical Engineers.

### Order by Specifying

1. Model Number
2. Temperature Range.
3. Stem Length.
4. Connection Nut Size.
5. Optional Features or Accessories required.
6. Any application other than normal, such as over range, high pressure or corrosive conditions. Give details.
7. If head is subjected to temperatures in excess of 300°F, state temperature.

### Shipping Weight

GT-300	12 oz.
GT-300R	12 oz.
MX-325R	12 oz.
GT-500	1 lb. 8 oz.
GT-500R	1 lb. 8 oz.

### IMMERSION

For most accurate reading with Tel-Tru thermometers immerse past groove on lower portion of stem.

2 1/2" stem thermometers should be completely immersed. If used with a limited space thermowell some reading error may be noticed depending on process and ambient temperatures. Consult with factory for further information.

# 1 3/4" & 2" Industrial Thermometers

## Back Connected

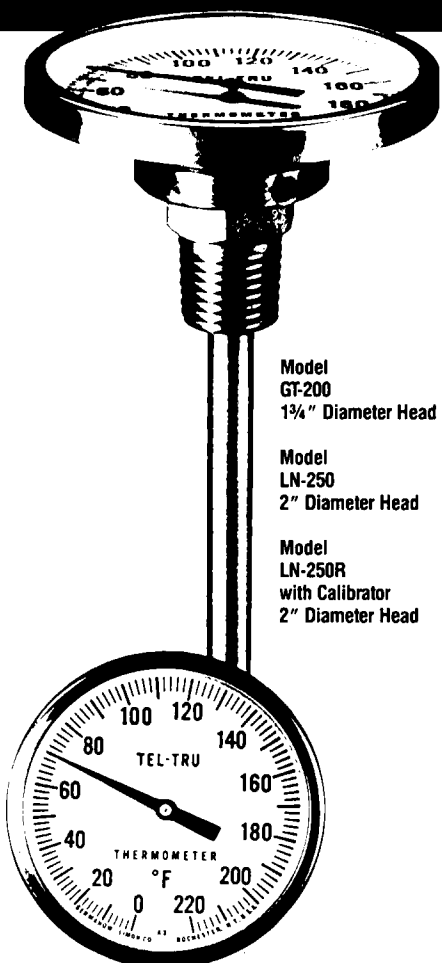

**Model GT-200**  
1 3/4" Diameter Head

**Model LN-250**  
2" Diameter Head

**Model LN-250R**  
with Calibrator  
2" Diameter Head

- Type 304 stainless steel.
- All welded construction.
- Model LN-250R easy to calibrate by loosening a socket head screw above hex connecting nut.
- Dials printed with large black numbers and graduations—easy to read from any angle.
- Glass lens standard—Lexan available.
- Rustproof—Dustproof—Leakproof. Hermetically sealed.
- Corrosion resistant to most chemicals.
- Model GT-200 standard 1/4" or 1/2" NPT. Stem diameter: .150" Standard stem lengths: 2 1/2", 4", 6", 9", 12", 18", 24", including threads
- Models LN-250 and LN-250R standard 1/4" NPT. Stem diameter: 1/4". Standard stem lengths: 2 1/2", 4", 6", 9", 12", 18", 24". Available in lengths up to 72" max., including threads.
- Actuated by super-sensitive bimetallic Helix Coil.
- Bimetal element dampened with silicone for minimum pointer vibration and maximum heat transfer.
- Accuracy to within ± 1% total scale range.
- Over-range protection 100% up to 250°F, 50% up to 500°F, 10% above 500°F.

\*Caution: Do not subject Lexan Crystals to temperatures above 300°F (150°C)

Lexan® is a registered trademark of General Electric Company, Inc.



Manufactured in USA by:  
**TEL-TRU Manufacturing Co.**  
P.O. Box 144  
Rochester, NY 14601 USA  
Phone: 716-232-1440 • 800-232-5335  
FAX: 716-232-3857  
Manufacturers of Precision Products Since 1916

**GT-200**

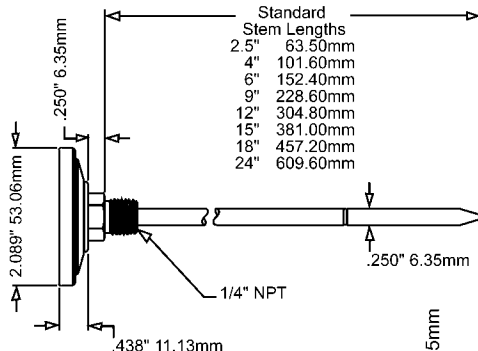
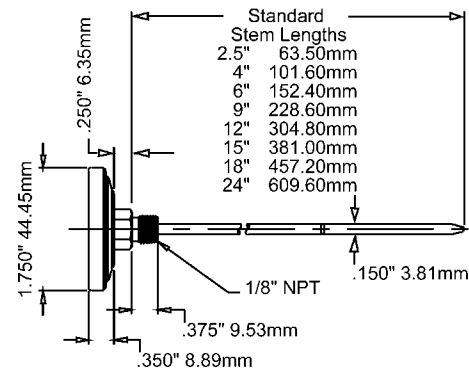

**LN-250**

**LN-250R with Calibrator**

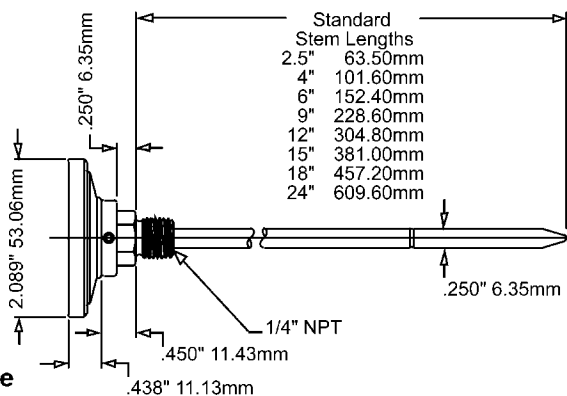

- Silicone filled models available for extreme vibration or low temperature applications.
- 3/8" Diameter stem available. (LN-250 and LN-250R only)

Temperature Ranges					
Fahrenheit	°/Div.	Celsius	°/Div.	°F	Dual °C
-100 to 100°	2°	-50 to 100°	1°	-100/100	-75/40
-40 to 160°	2°	-50 to 50°	1°	-40/160	-40/70
0 to 140°	2°	-50 to 25°	1°	0/180	-18/82
0 to 180°	2°	-40 to 70°	1°	0/220	-10/100
0 to 220°	2°	-10 to 110°	1°	20/240	-10/110
20 to 240°	2°	0 to 50°	1/2°	25/125	0/50
25 to 125°	1°	0 to 100°	1°	50/300	10/150
50 to 250°	2°	0 to 150°	1°	50/400	0/200
50 to 300°	2°	0 to 200°	2°	50/500	0/250
50 to 400°	5°	0 to 250°	2°	150/750	50/400
50 to 500°	5°	0 to 300°	5°	†200/1000	100/550
150 to 750°	10°	100 to 400°	5°		
†200 to 1000°	10°	†100 to 550°	5°		

\*Not recommended for continuous use above 800°F or 425°C

†Available in Calibrator models only.

Tempered Crystal available at extra charge.

Additional dial ranges and stem lengths available.

Thermowells are recommended for pressure, corrosive fluid or high velocity applications.

### ASME B40.3

Bimetal thermometers manufactured by Tel-Tru and offered in this catalog are designed to meet or exceed this Standard issued by the American Society of Mechanical Engineers.

## Order by Specifying

1. Model Number
2. Temperature Range.
3. Stem Length.
4. Connection Nut Size.
5. Optional Features or Accessories required.
6. Any application other than normal, such as over range, high pressure or corrosive conditions. Give details.
7. If head is subjected to temperatures in excess of 300°F, state temperature.

## Shipping Weight

<b>GT-200</b>	4 oz.
<b>LN-250</b>	6 oz.
<b>LN-250R</b>	6 oz.

### IMMERSION

For most accurate reading with Tel-Tru thermometers immerse past groove on lower portion of stem.  
2 1/2" stem thermometers should be completely immersed. If used with a limited space thermowell some reading error may be noticed depending on process and ambient temperatures. Consult with factory for further information.

# 1 3/4", 2", 3" Laboratory Thermometers

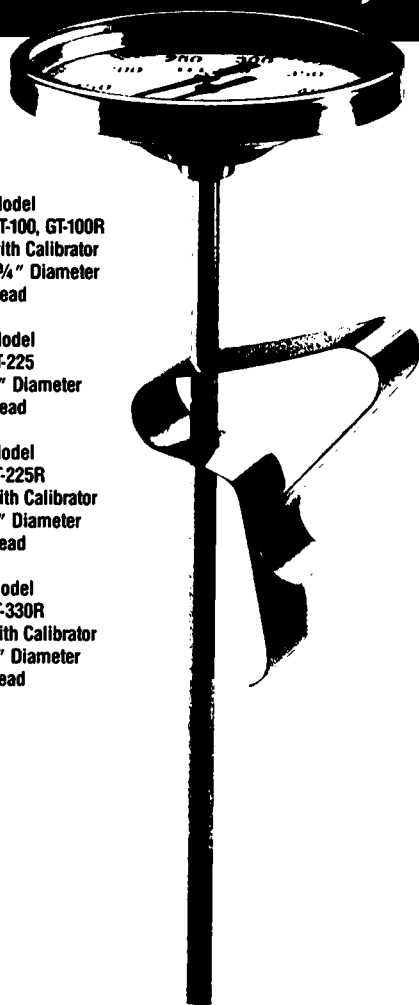

**Model  
GT-100, GT-100R  
with Calibrator  
1 3/4" Diameter  
Head**

**Model  
LT-225  
2" Diameter  
Head**

**Model  
LT-225R  
with Calibrator  
2" Diameter  
Head**

**Model  
LT-330R  
with Calibrator  
3" Diameter  
Head**

- Type 304 stainless steel.
- All welded construction.
- Model GT-100R, LT-225R, LT-330R friction design—easy to calibrate.
- Dials printed with large black numbers and graduations—easy to read from any angle.
- Crystals: GT-100, GT-100R, LT-225, LT-225R Glass standard—Lexan available. LT-330R—Lexan standard.
- Stem Diameter: .150"; stem length 8".
- Rustproof—Dustproof—Leakproof. Hermetically sealed.
- Corrosion resistant to most chemicals.
- Actuated by super-sensitive bimetallic Helix Coil.
- Bimetal element dampened with silicone for minimum pointer vibration and maximum heat transfer.
- Accuracy to within  $\pm 1\%$  total scale range.
- Over-range protection 100% up to 250°F, 50% up to 500°F, 10% above 500°F (250°C).
- Adjustable clamp for tank and tray mounting.

*\*Caution: Do not subject Lexan Crystals to temperatures above 300°F (150°C)*

Lexan® is a trademark of General Electric Company, Inc.



Manufactured in USA by:  
**TEL-TRU Manufacturing Co.**  
P.O. Box 144  
Rochester, NY 14601 USA  
Phone: 716-232-1440 • 800-232-5335  
FAX: 716-232-3857  
Manufacturers of Precision Products Since 1916

## Testing and General Purpose

**GT-100**

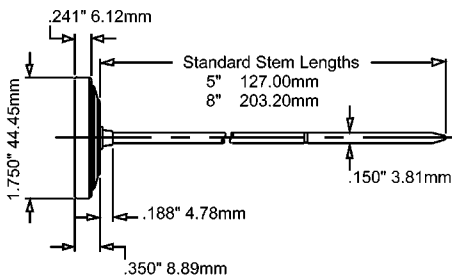

**LT-225**

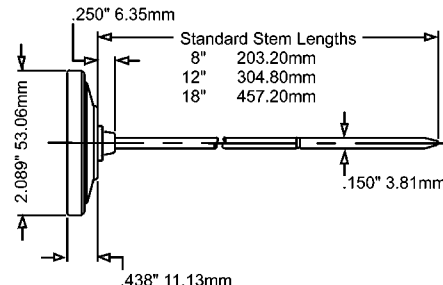

**GT-100R  
with Calibrator**

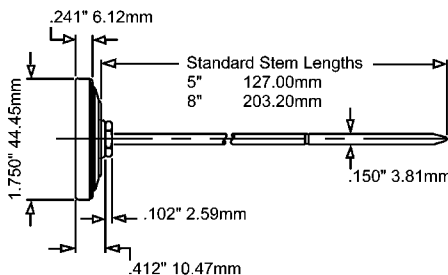

**LT-225R  
with Calibrator**

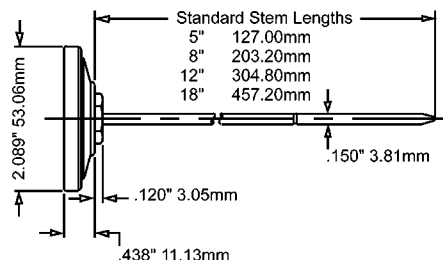

**LT-330R  
with Calibrator**

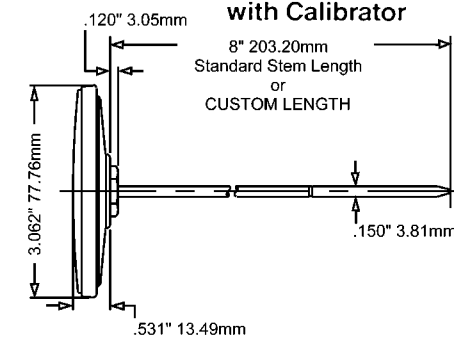

GT-100, GT-100R, LT-225, LT-225R					
Temperature Ranges					
Fahrenheit		%Div.	Celsius		Dual °C
-100 to 100	100°	2°	-50 to 100	1°	-100/100 -75/40
-40 to 160	2°	2°	-50 to 50	1°	-40/160 -40/70
0 to 140	2°	2°	-50 to 25	1°	0/180 -18/82
0 to 180	2°	2°	-40 to 70	1°	0/220 -10/100
0 to 220	2°	2°	-10 to 110	1°	20/240 -10/110
20 to 240	2°	2°	0 to 50	1/2°	25/125 0/50
25 to 125	1°	1°	0 to 100	1°	50/300 10/150
50 to 250	2°	2°	0 to 150	1°	50/400 0/200
50 to 300	2°	2°	0 to 200	2°	50/500 0/250
50 to 400	5°	5°	0 to 250	2°	150/750 50/400
50 to 500	5°	5°	0 to 300	5°	†200/1000 100/550
150 to 750	10°	10°	100 to 400	5°	
†200 to 1000	10°	10°	†100 to 550	5°	

LT-330R			
Temperature Ranges			
Dual Scale			
Fahrenheit (Black)	%Div.	Celsius (Red)	%Div.
-100 to 100°	2°	-75 to 40°	2°
-40 to 160°	2°	-40 to 70°	1°
0 to 220°	2°	-10 to 100°	1°
25 to 125°	1°	0 to 50°	1/2°
50 to 300°	2°	10 to 150°	2°
50 to 500°	5°	0 to 250°	2°
150 to 750	10°	50 to 400°	5°
†200 to 1000	10°	†100 to 550°	5°

\*Not recommended for continuous use above 800°F or 425°C  
†Available in Calibrator models only.

Tempered Crystal available (2" models only). Additional dial ranges and stem lengths available.

### ASME B40.3

Bimetal thermometers manufactured by Tel-Tru and offered in this catalog are designed to meet or exceed this Standard issued by the American Society of Mechanical Engineers.

### Order by Specifying

1. Model Number
2. Temperature Range.
3. Stem Length.
4. Any application other than normal, such as over range, high pressure or corrosive conditions. Give details.
5. If head is subjected to temperatures in excess of 300°F, state temperature.

### Shipping Weight

<b>GT-100</b> .....	4 oz.
<b>GT-100R</b> .....	4 oz.
<b>LT-225</b> .....	4 oz.
<b>LT-225R</b> .....	4 oz.
<b>LT-330R</b> .....	4 oz.

### IMMERSION

For most accurate reading with Tel-Tru thermometers immerse past groove on lower portion of stem.

# 1" & 1 3/8" Testing Thermometers

## Pocket Spot Check

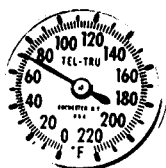

**Model  
PT-50,  
PT-50R, AD-10R  
with Calibrator  
1" Diameter Head**

**Model  
AD-44R  
with Calibrator  
1 3/8" Diameter Head**

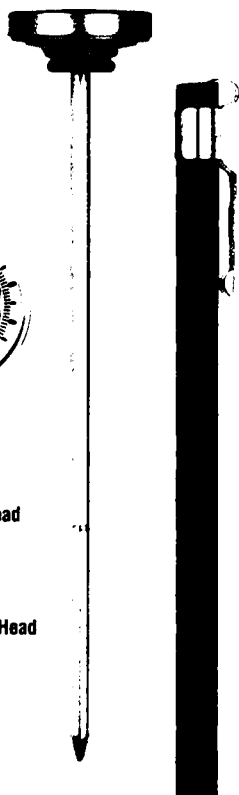

- Type 304 stainless steel.
- All welded construction.
- Model PT-50 with 1/4"-28 connection or Plain bushing for OEM or special applications.
- Models PT-50R, AD-10R and AD-44R friction design—easy to calibrate.
- Dials printed with large black numbers and graduations—easy to read from any angle.
- Head diameters 1" and 1 3/8"; stems 5" long by .150" diameter.
- Rustproof—Dustproof—Leakproof. Hermetically sealed.
- Corrosion resistant to most chemicals.
- Actuated by super-sensitive bimetallic Helix Coil.
- Bimetal element dampened with silicone for minimum pointer vibration and maximum heat transfer.
- Accuracy PT-50R, AD-44R to within  $\pm 1\%$  total scale range. Accuracy AD-10R commercial grade  $\pm 2-1-2\%$ .
- Over-range protection 100% up to 250°F, 50% up to 500°F, 10% above 500°F. (250°C).
- Models PT-50, PT-50R supplied with Lexan® unbreakable crystals as standard on ranges up to 300° (150°C). Glass Crystals supplied on higher ranges.
- Models AD-10R, AD-44R supplied with Lexan® unbreakable crystals only.
- Plastic carrying case with clip.

\*Caution: Do not subject Lexan Crystals to temperatures above 300°F (150°C)

Lexan® is a registered trademark of General Electric Company, Inc.



Manufactured in USA by:  
**TEL-TRU Manufacturing Co.**  
P.O. Box 144  
Rochester, NY 14601 USA  
Phone: 716-232-1440 • 800-232-5335  
FAX: 716-232-3857  
Manufacturers of Precision Products Since 1916

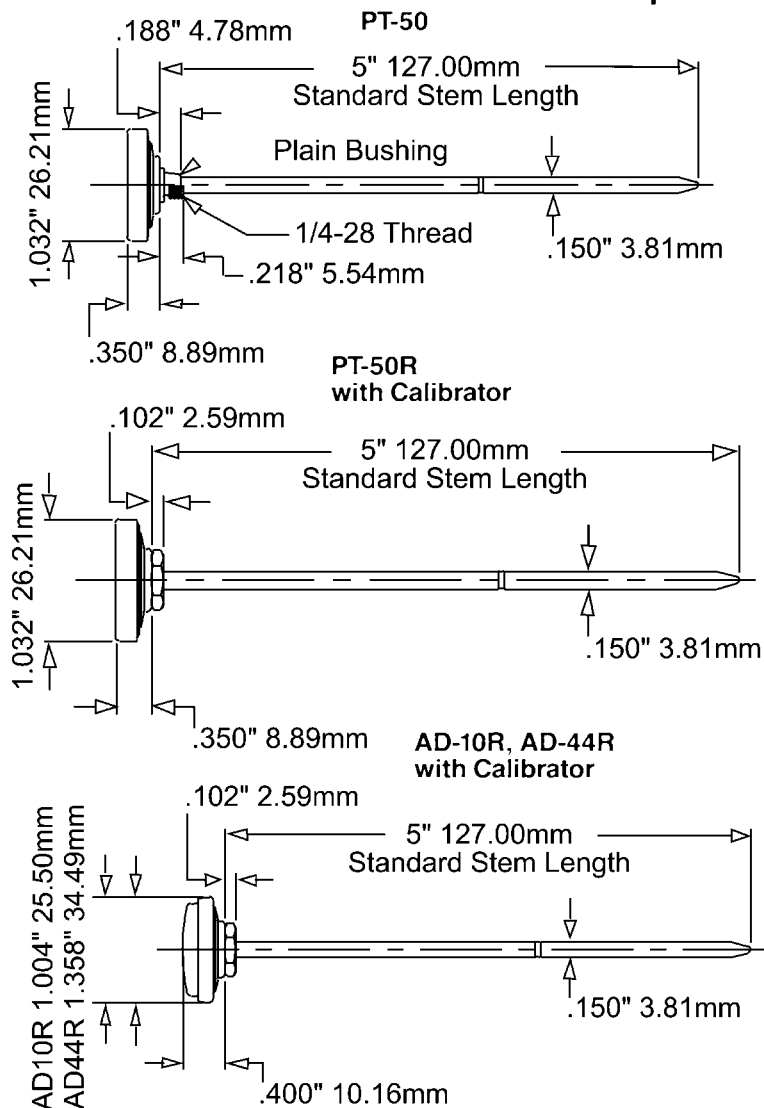

Temperature Ranges			
Fahrenheit	%Div.	Celsius	%Div.
-40 to 160°	2°	-40 to 70°	1°
25 to 125°	1°	-10 to 110°	1°
0 to 220°	2°	0 to 50°	1/2°
50 to 500°	5°	0 to 250°	5°
150 to 750°	10°		

Additional dial ranges and stem lengths available.



### Order by Specifying

**Models PT-50R, AD-10R, AD-44R**

1. Model Number
2. Temperature Range.
3. Type of Packaging.

**Model PT-50 for OEM or Special Applications**

1. Model Number
2. Temperature Range
3. Stem Length (standard or special)
4. Connection
5. Any application other than normal, such as over range, high pressure or corrosive conditions. Give details.
6. If head is subjected to temperatures in excess of 300°F, state temperature.

### Shipping Weight

All Models ..... 1 oz.

#### IMMERSION

For most accurate reading with Tel-Tru thermometers immerse past groove on lower portion of stem.

#### ASME B40.3

Bimetal thermometers manufactured by Tel-Tru and offered in this catalog are designed to meet or exceed this Standard issued by the American Society of Mechanical Engineers.

# Bimetal Thermometer Options and Accessories



Custom  
Dial Markings

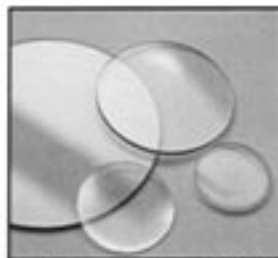

Plastic, Tempered or Shatterproof  
Glass Windows



Special Stem  
Lengths & Connections



Thermowell Adapter Kits



Tagging



Mounting Flanges

## Other Product Catalogs



Gas Actuated  
Thermometers  
Cat. 9150



Vapor Tension  
Thermometers  
Cat. 8549



Glass Industrial  
Thermometers  
Cat. 9002



Surface  
Thermometers  
Cat. 9302



Non-Contact  
Thermometers  
Cat. 9600



Thermometer  
Thermowells  
Cat. 8430



Pressure  
Gauges  
Cat. 9500



Manufactured in USA  
**TEL-TRU Manufacturing Co.** • P.O. Box 144, Rochester, NY 14601 USA  
 Phone: 716-232-1440 • 800-232-5335 • FAX: 716-232-3857  
 Manufacturers of Precision Products Since 1916

E-mail: [info@teltru.com](mailto:info@teltru.com)  
 Web: <http://www.teltru.com>

Cat. 8910  
 Printed in USA  
 1/98